

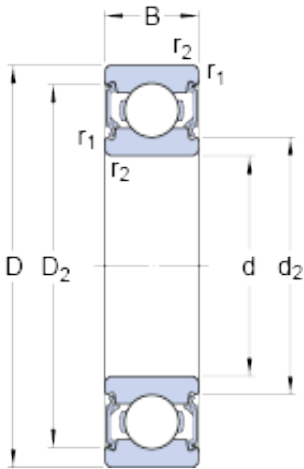

BEARING DRIVESHAFT ANDERSON, INC.



6004-2RSL Bearing 2D drawings and 3D CAD models

20 mm x 42 mm x 12 mm SKF 6004-2RSL Ball bearing

Bearing No. 6004-2RSL

Size	42x20x12 mm
Bore Diameter	42 mm
Outer Diameter	20 mm
Width	12 mm
d	20 mm
D	42 mm
B	12 mm
d ₂	24.65 mm
D ₂	37.19 mm
r _{1,2} - min.	0.6 mm
d _a - min.	23.2 mm
d _a - max.	24.5 mm
D _a - max.	38.8 mm
r _a - max.	0.6 mm
Basic dynamic load rating - C	10 kN
Basic static load rating - C ₀	5 kN
Fatigue load limit - P _u	0.212 kN
Reference speed	38000 r/min
Limiting speed	19000 r/min
Calculation factor - k _r	0.025
Calculation factor - f ₀	14
Category	Single Row Ball Bearings
Inventory	0.0
Manufacturer Name	SKF



BEARING DRIVESHAFT ANDERSON, INC.

Minimum Buy Quantity	N/A
Weight / Kilogram	0.075
EAN	7316571823829
Product Group	B00308
Enclosure	2 Seals
Precision Class	ABEC 1 ISO P0
Maximum Capacity / Filling Slot	No
Rolling Element	Ball Bearing
Snap Ring	No
Internal Special Features	No
Cage Material	Steel
Enclosure Type	Contact Seal
Internal Clearance	C0-Medium
Inch - Metric	Metric
Long Description	20MM Bore; 42MM Outside Diameter; 12MM Outer Race Width; 2 Seals; Ball Bearing; ABEC 1 ISO P0; No Filling Slot; No Snap Ring; No Internal Special Features; C0-Medium Internal Clearance; Steel Cage;
Other Features	Deep Groove Low Friction NBR Seal
Category	Single Row Ball Bearing
UNSPSC	31171504
Harmonized Tariff Code	8482.10.50.68
Noun	Bearing
Keyword String	Ball
Manufacturer URL	http://www.skf.com
Manufacturer Item Number	6004-2RSL
Weight / LBS	0.158
Inner Race Width	0 Inch 0 Millimeter



BEARING DRIVESHAFT ANDERSON, INC.

Bore	0.787 Inch 20 Millimeter
Outer Race Width	0.472 Inch 12 Millimeter
Outside Diameter	1.654 Inch 42 Millimeter
d_2	24.65 mm
D_2	37.19 mm
$r_{1,2}$ min.	0.6 mm
d_a min.	23.2 mm
d_a max.	24.5 mm
D_a max.	38.8 mm
r_a max.	0.6 mm
Basic dynamic load rating C	9.95 kN
Basic static load rating C_0	5 kN
Fatigue load limit P_u	0.212 kN
Calculation factor k_r	0.025
Calculation factor f_0	14
Mass bearing	0.069 kg