

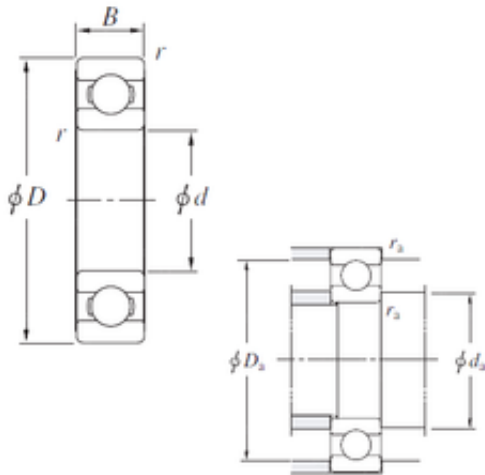

# BEARING DRIVESHAFT ANDERSON, INC.



SB530 Bearing 2D drawings and 3D CAD models

530 mm x 760 mm x 100 mm KOYO SB530 Ball bearing

Bearing No. SB530

Size	530x760x100 mm
Bore Diameter	530 mm
Outer Diameter	760 mm
Width	100 mm
d	530 mm
D	760 mm
B	100 mm
r min.	6 mm
da min.	554 mm
Da max.	736 mm
ra max.	5 mm
Weight	144 Kg
Basic dynamic load rating (C)	621 kN
Basic static load rating (C0)	1180 kN