

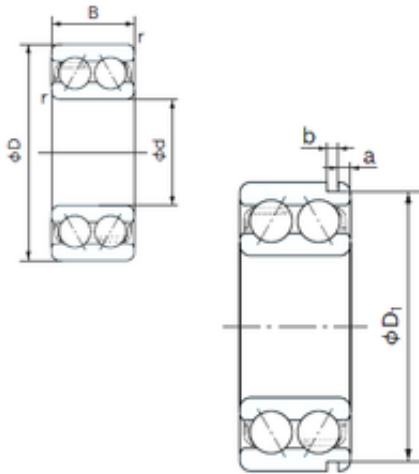

BEARING DRIVESHAFT ANDERSON, INC.



20 mm x 47 mm x 20.6 mm NACHI 5204N
Angular contact ball bearing

Bearing No. 5204N

5204N Bearing 2D drawings and 3D CAD models

Size	20x47x20.6 mm
Bore Diameter	20 mm
Outer Diameter	47 mm
Width	20.6 mm
d	20 mm
D	47 mm
B	20.6 mm
C	20.6 mm
a	2.46 mm
b	1.35 mm
r min.	1 mm
D1	44.6 mm
Weight	0.120 Kg
Basic dynamic load rating (C)	20 kN
Basic static load rating (C0)	12,7 kN
(Grease) Lubrication Speed	10000 r/min
Bore Type	Cylindrical Bore
Enclosure	Open
Configuration	Double Row
Bore Size	20 mm
Outside Diameter	47 mm
Width	20.6 mm
Fillet Radius/Chamfer	1 mm
Groove Width	1.4 mm
Groove Diameter	44.6 mm



BEARING DRIVESHAFT ANDERSON, INC.

a (max)	2.5 mm
Dynamic Load Rating	20,000 N
Static Load Rating	12,700 N
Limiting Speed - Grease	10,000 rpm
Limiting Speed - Oil	14,000 rpm
Radial Clearance	0.005 to 0.020 mm
da	26 mm
Da	41 mm
Dx	53.5 mm
ra	1 mm
Cy	3.3 mm